

MOTE & ASSOCIATES, INC

Commercial Real Estate for Southwest Dallas

For Lease

Floor Plan

312/315 E. Camp Wisdom Rd., Duncanville

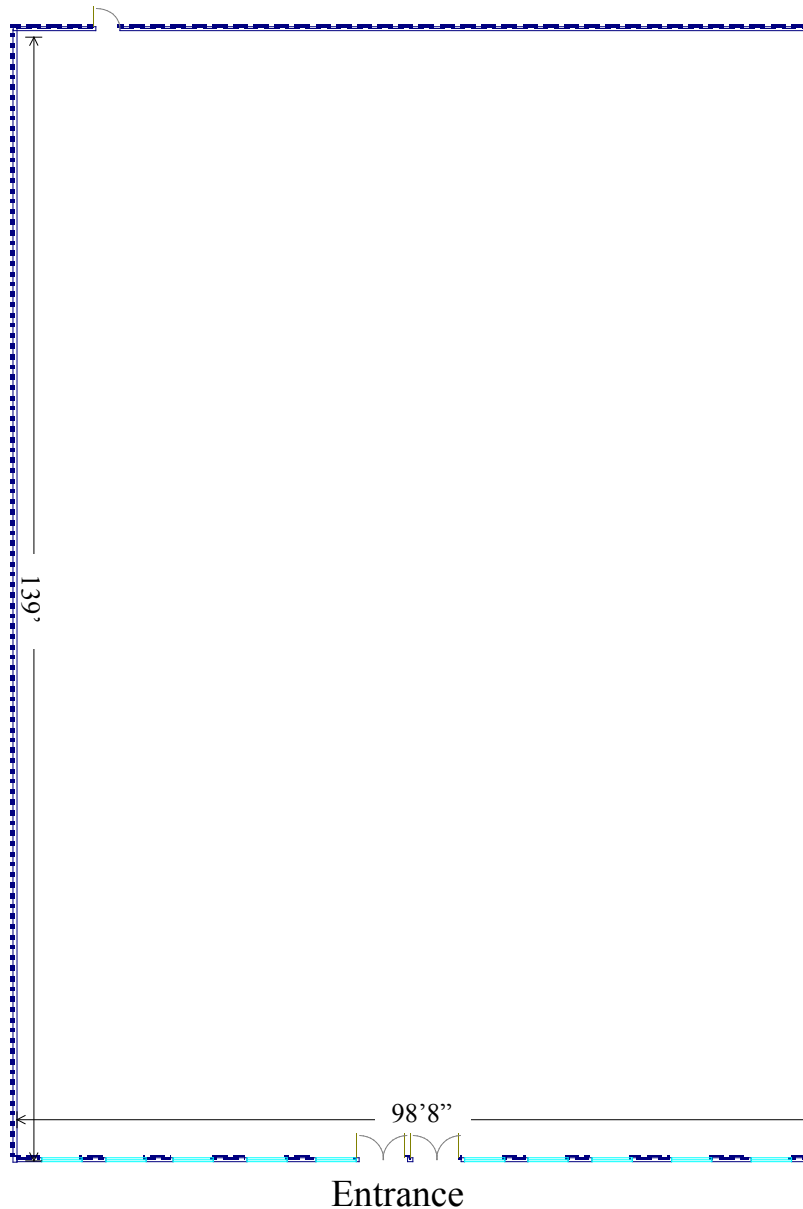

Offered for lease exclusively by:

Mote & Associates, Inc.

Contact: Sarah R. Mitchell

515 N. Cedar Ridge, Suite 9 Duncanville, Texas 75116

972-296-2856 fax 972-709-4170

sarahm@moteandassociates.com

All information has been obtained from a source deemed reliable but is not guaranteed, and broker makes no warranties of any kind with respect to accuracy of such information. All sq. ft./acreage is based on information obtained from county data records. Price subject to change without notice.